

# Pupil Accommodation Committee (PAC) Working Group Follow-Up Meeting

- ◆ **To provide the Orillia Pupil Accommodation Committee with an information update**



1. a) **Alternative Site Review**  
b) **Additional property for MLE site**
  
2. **Site Design Concepts**
  - a) **St. Bernard's**
  - b) **Monsignor Lee / Guardian Angels**
  
3. **Interim Accommodations**
  
4. **Funding Information**
  
5. **Summary of Schedule**



# ALTERNATIVE SITE REVIEW

<u>MAP#</u>	<u>SITE LOCATION</u>	<u>SITE SIZE</u>	<u>OTHER COMMENTS</u>	<u>MEETS CRITERIA of PAC</u>	<u>Meets SMCDSB Site Designation and Acquisition Policy</u>
E	Sundial Property	7.76 acres	Beyond 1.6 Km; Irregular	NO	NO
F	Corner of Hughes Rd. & Laclie St.	>5 acres	Too small; Irregular	NO	NO
G	Drinkwater Drive across from Wetland	>5 acres	Too small; Irregular	NO	NO
H	Drinwater Drive near Fittton's Road	>5 acres	Too small; Irregular	NO	NO
I	Property on Carlyon Line (Severn TWP)	13.69 acres	Beyond 1.6 Km and on north side of Hwy 11	NO	No-Full municipal servicing not available
J	Property formerly known as the Pav	Approx. 2 acres	Too Small	NO	NO
HCR	SCDSB – Hillcrest	2.7 acres	Too small	NO	NO
MOU	SCDSB – Mount Slaven	2.9 acres	Too small	NO	NO
DCH	SCDSB – David H. Church	5.29 acres	Beyond 1.6 km and too close to SBE	NO	YES
	SCDSB – Orillia Central	1.54 acres	Too small	NO	NO
ODC	SCDSB - ODCVI	9.4 acres	SCDSB decision is pending funding therefore NOT AVAILABLE	N/A No timing on funding	N/A No timing on funding

## ADDITIONAL PROPERTY for MLE SITE

- Review of Options



# ORILLIA PUPIL ACCOMMODATION REVIEW PROPERTY REVIEW



- Local Landmarks**
1. Wetland
  2. Sundial
  3. Kubota
  4. Golf Course
  5. Cemetary
  6. Zehrs
  7. Highwayman Inn
  8. Lion's Oval
  9. Couchiching Beach Park
  10. Opera House
  11. Hospital
  12. City Hall
- Properties Adjacent to MLE**
- A. Bell Canada - 12 Fitton's Road E
  - B. Orillia Lawn Bowling Club - 1 Commerce Dr
  - C. Kubota - 25 Commerce Dr
  - D. Elizabeth Overend Housing
- Alternative Sites**
- E. Sundial Inn
  - F. Corner of Hughes Road & Laclie Street
  - G. Drinkwater Dr across from Wetland
  - H. Drinkwater Dr near Fitton's Road
  - I. Property in Severn Township (Carolyn Line)
  - J. Property formerly known as the Pav

- Legend**
- Roads
  - Catholic Elementary School
  - Public Elementary School
  - Public Secondary School
  - Catholic Secondary School

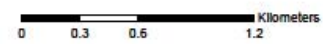

Orillia Accommodation Review  
Property Review  
As of: October 26, 2009



## **SITE DESIGN CONCEPTS**

**a) ST. BERNARD'S**

**b) MONSIGNOR LEE / GUARDIAN ANGELS**





ST. BERNARD'S ELEMENTARY SCHOOL  
255 OXFORD STREET  
ORILLIA, ONTARIO  
PHASE 1 — PARTIAL DEMOLITION /  
CONSTRUCTION SET-UP

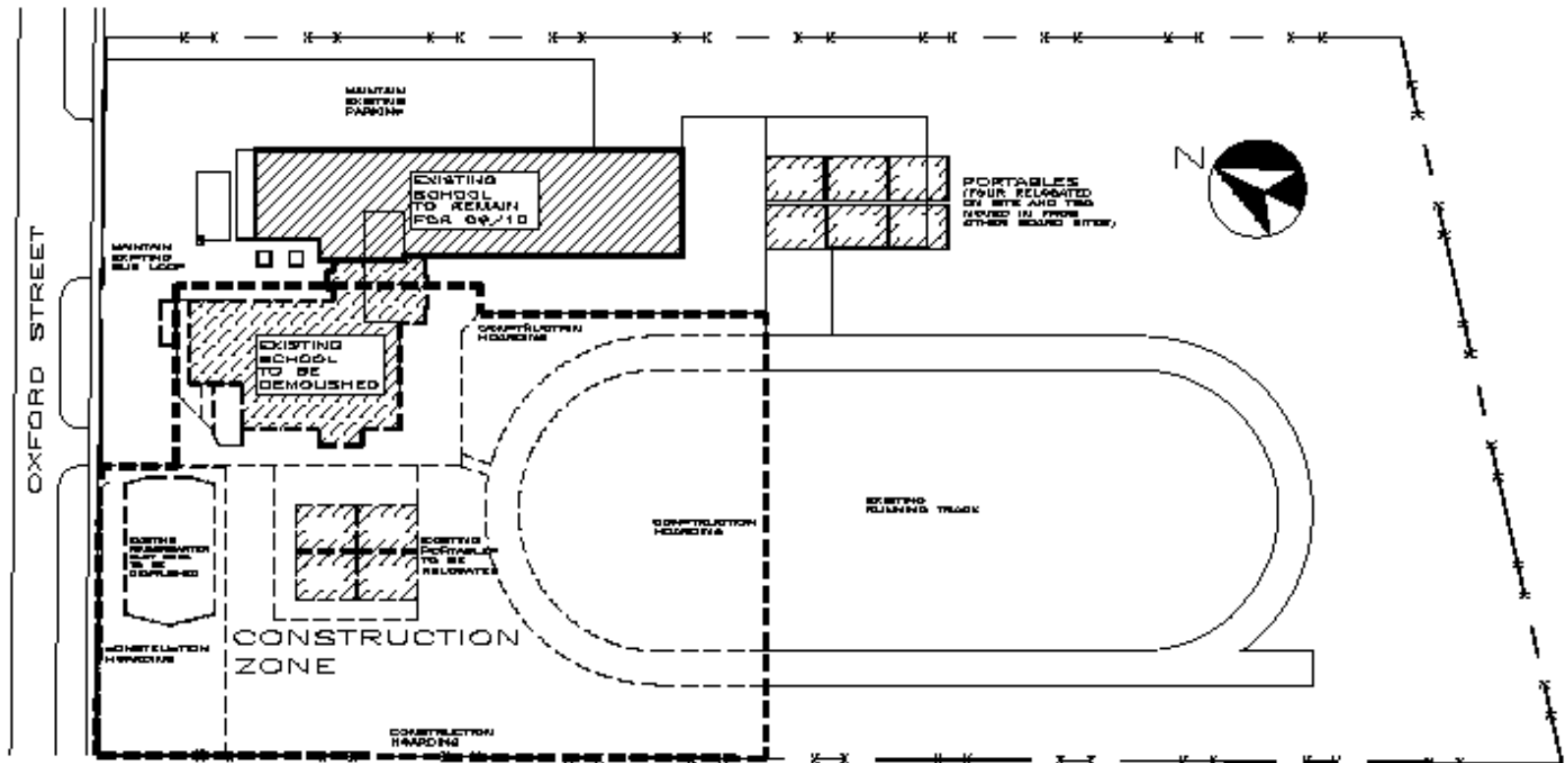

SITE PLAN



ST. BERNARD'S ELEMENTARY SCHOOL  
255 OXFORD STREET  
ORILLIA, ONTARIO  
PHASE 2 - CONSTRUCTION OF  
NEW TWO STOREY SCHOOL

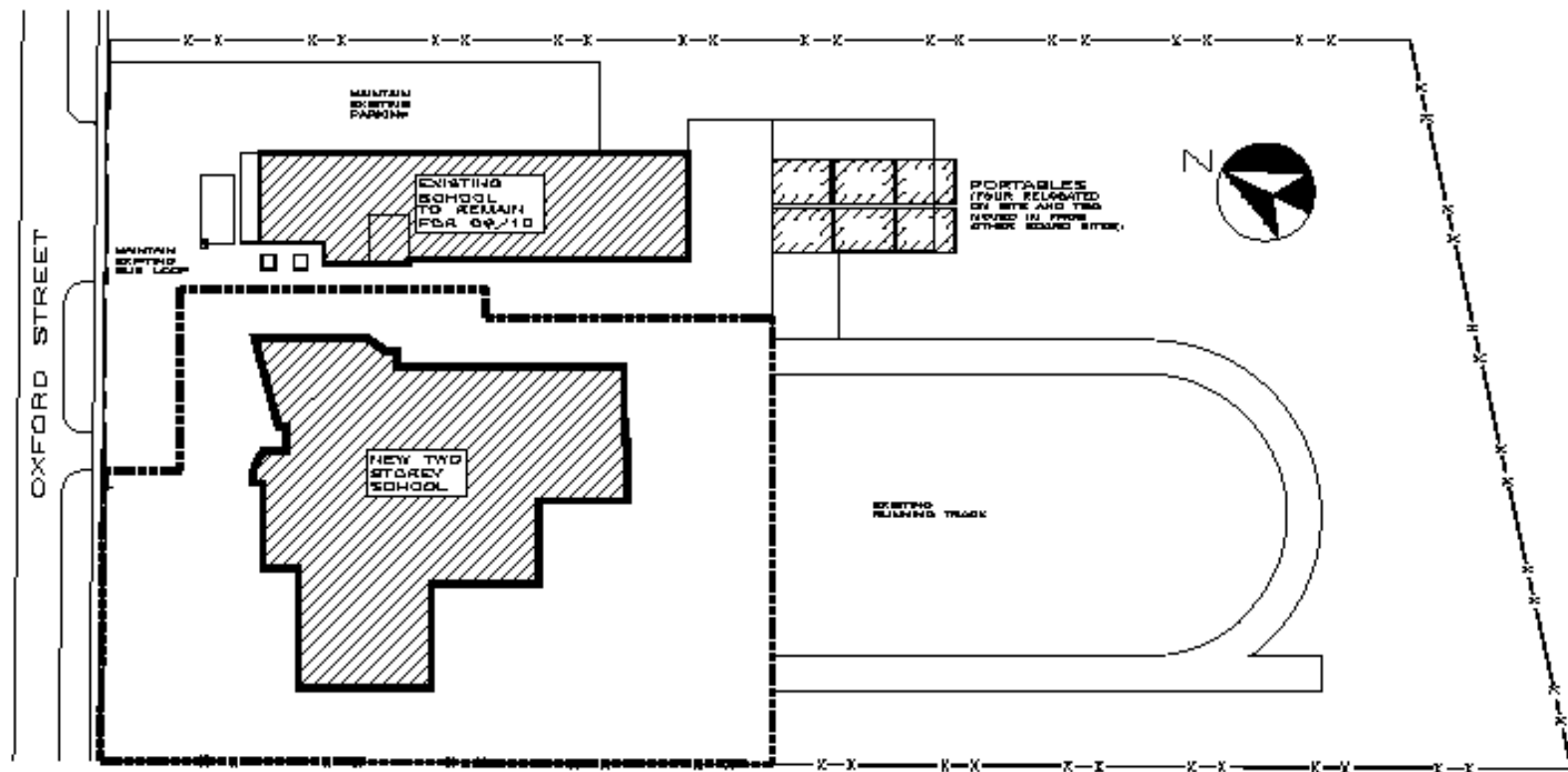

SITE PLAN





ST. BERNARD'S ELEMENTARY SCHOOL  
255 OXFORD STREET  
ORILLIA, ONTARIO  
PHASE 3 — COMPLETE DEMOLITION /  
REMOVE PORTABLES & HOARDING

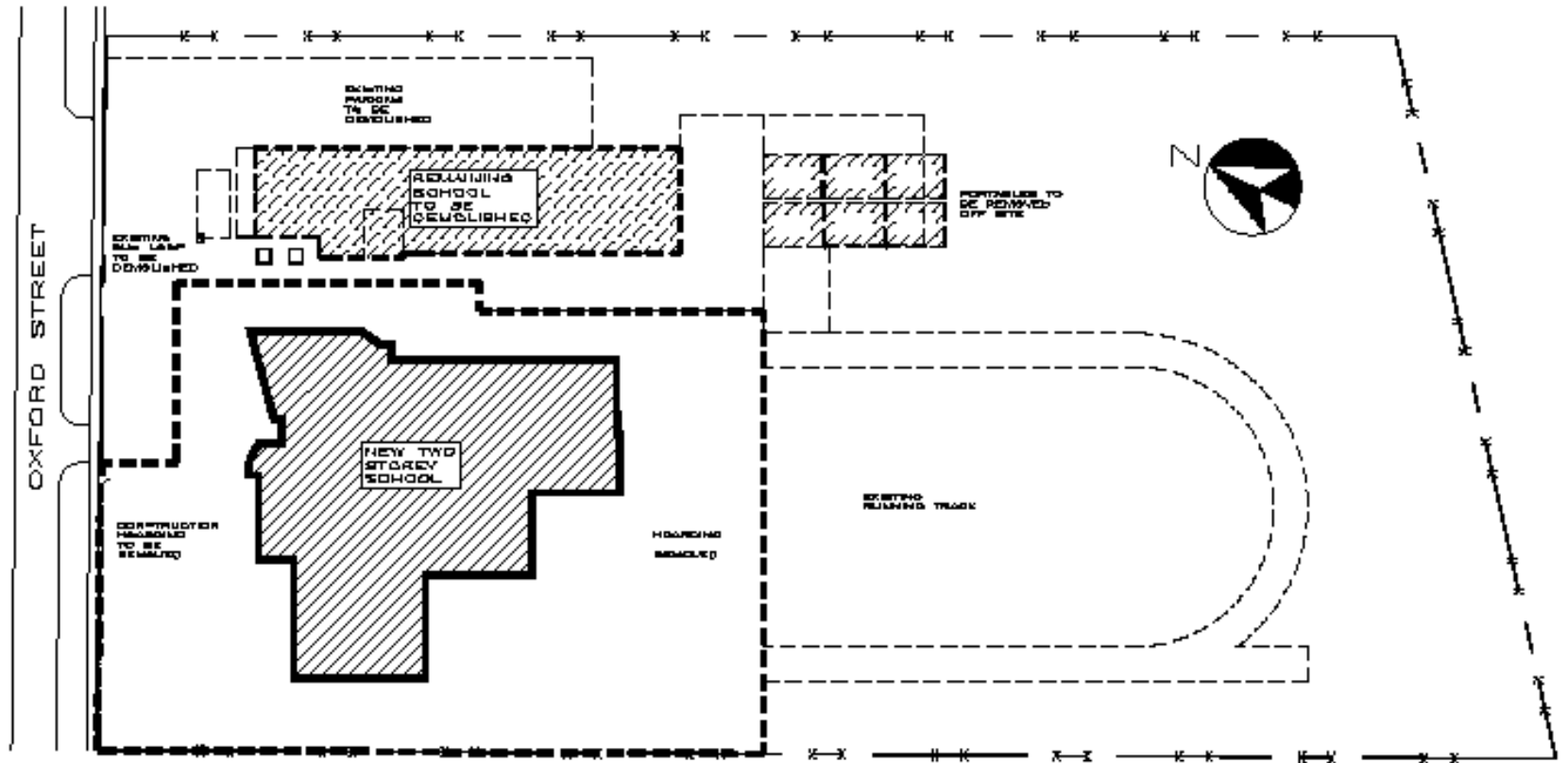

SITE PLAN



ST. BERNARD'S ELEMENTARY SCHOOL  
255 OXFORD STREET  
ORILLIA, ONTARIO  
PHASE 4 — COMPLETE EXTERIOR  
SITE WORK

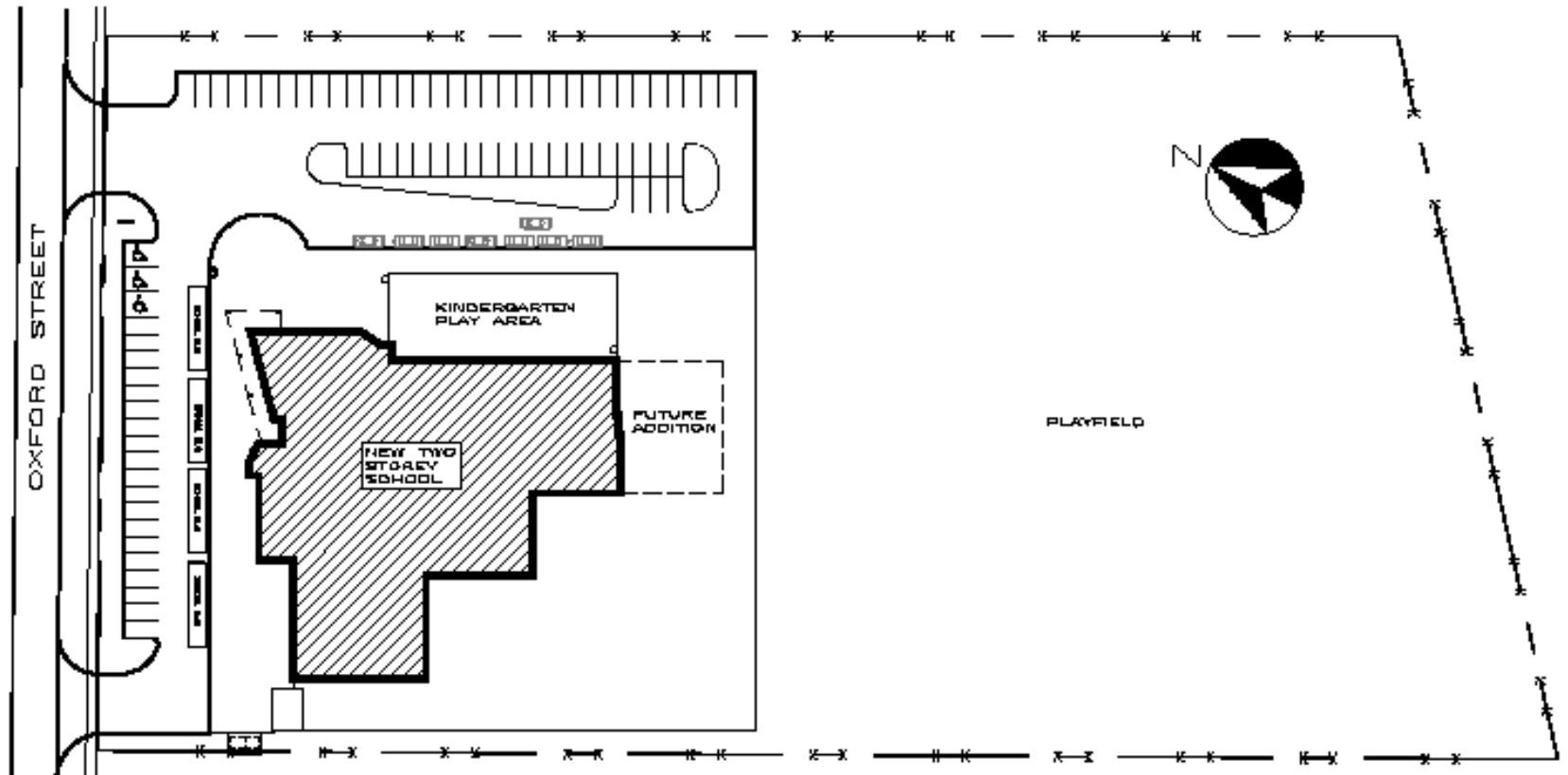

SITE PLAN

# GAN / MLE ADDITION 2 STOREY OPTION

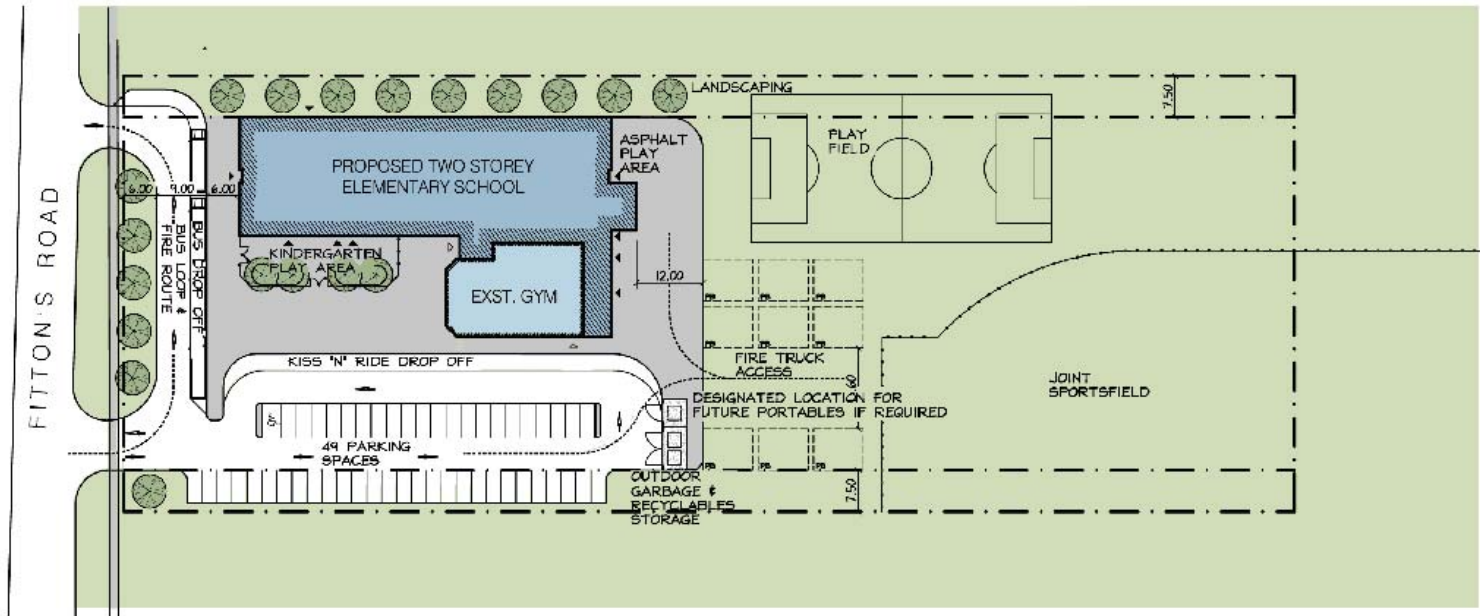

Site Plan  
**Monsignor Lee Catholic School**

Option 1: Proposed Two-Storey Building with Existing Gymnasium - Total Estimated Cost \$7,503,300.00



Robertson Simmons  
architects inc.

October 2009

# GAN / MLE ADDITION 3 STOREY OPTION

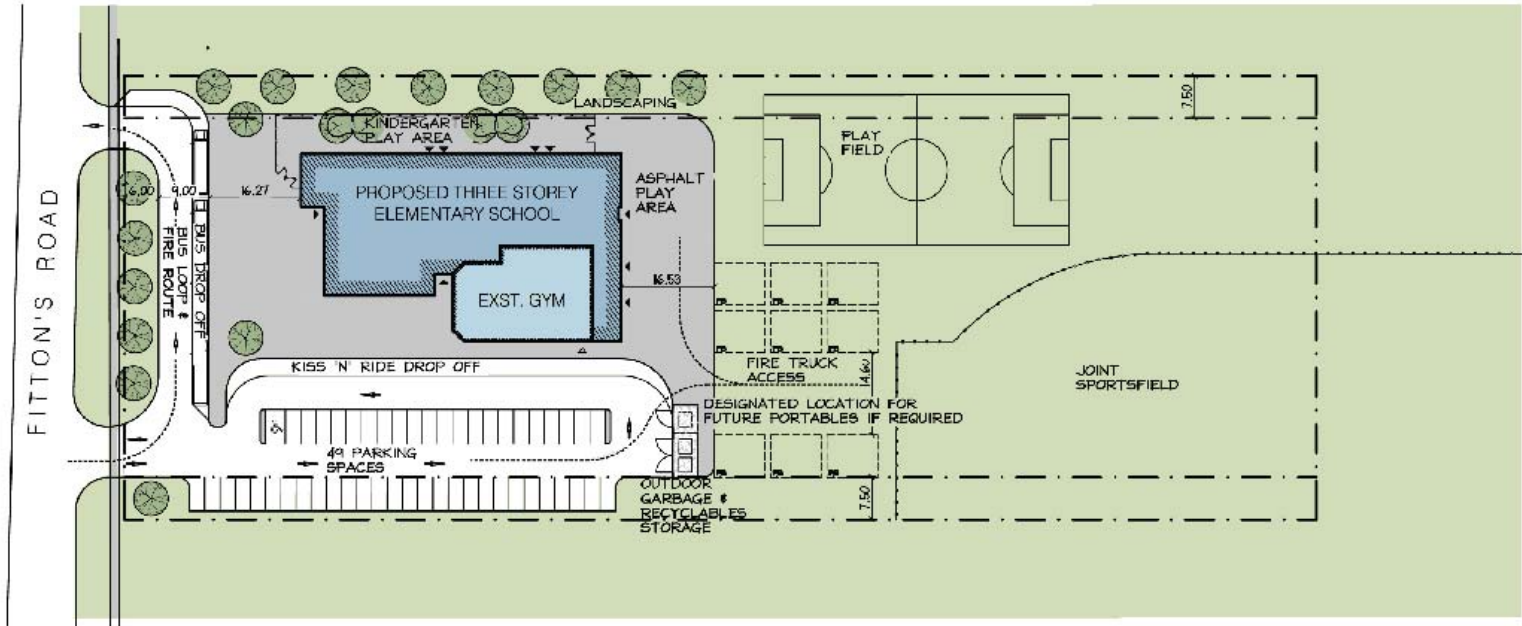

Site Plan  
**Monsignor Lee Catholic School**

Robertson **Simmons** architects inc.

Option 2: Proposed Three-Storey Building with Existing Gymnasium - Total Estimated Cost \$7,769,350.00

October 2009

# GAN / MLE ADDITION

## 3 STOREY NEW BUILDING OPTION

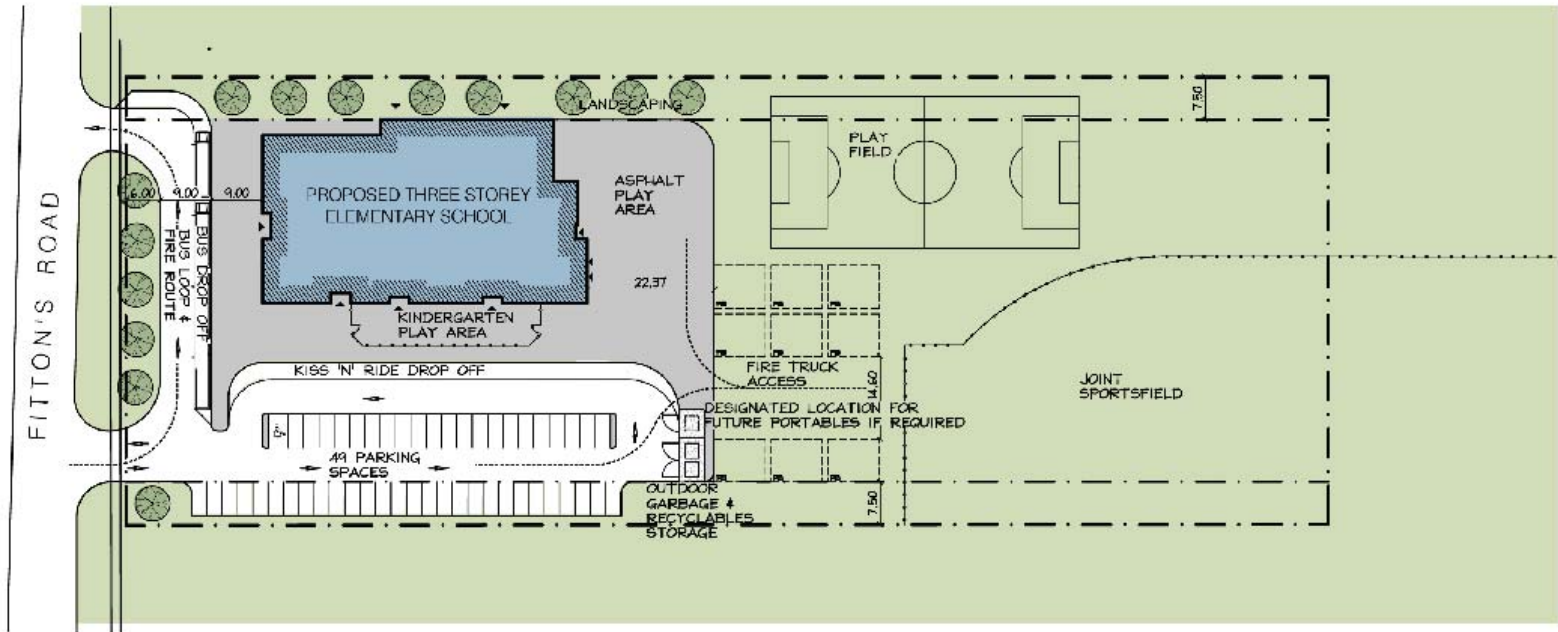

SCALE IN METRES 0 7.5 15 30 45 60 75

Robertson **Simmons** architects inc.



Site Plan  
**Monsignor Lee Catholic School**

Option 3: Proposed Three-Storey Building - Total Estimated Cost \$8,342,929.00

October 2009

## INTERIM ACCOMMODATIONS

a) ALTERNATIVE LOCATIONS

b) EXISTING SITES



# FUNDING INFORMATION

## Capital Funding Allocation for Orillia

Planning Approval Received for Capital Funding Allocation for Orillia 2009	Fall	BUDGET ESTIMATE	FUNDING	OTHER FUNDING FOR CONSIDERATION FOR THIS PROJECT	OTHER FUNDING TO BE REQUESTED FROM MINISTRY
Review of Funding and Project Estimates			PCS - Orillia	e.g. GPL, Renewal, Energy	Request for Demolition costs and site servicing
SBE Replacment Project (Building, Demo, Site)	\$	9,407,000.00			
MLE / GAN Replacement Project (Building, Demo, Site)	\$	9,100,250.00			
<b>TOTAL FUNDS NEEDED FOR ORILLIA SOLUTION (OPTION B)</b>	<b>\$</b>	<b>18,507,250.00</b>			
Planning Approval Received			\$ 12,470,000.00		
PCS Capital Allocation (Orillia)			\$ 1,479,139.20		
Other Available Funding (existing sources)				\$ 2,519,725.00	
Other Funding to request (Demo and Site Servicing) - estimated at \$1Million/ project for a total of \$2 Million					\$ 2,000,000.00
<b>SUMMARY OF FUNDING FOR CONSIDERATION</b>	<b>\$</b>	<b>-</b>	<b>\$ 13,949,139.20</b>	<b>\$ 2,519,725.00</b>	<b>\$ 2,000,000.00</b>
					<b>\$ 18,468,864.20</b>

## SUMMARY OF SCHEDULE

- ✓ November 25, 2009  
**Board to Consider School Accommodation**
- ✓ November 26, 2009  
**Notice of Decision**
- ✓ Next Steps





# CLOSING PRAYER

